

# Cerafill RCS®

Bioceramic Root Canal Filling and Sealing Material

**Cerafill RCS** is a ready to use injectable premixed filling and sealing material which is based on the bioceramic technology. It is an alumina free calcium silicate based material with excellent handling characteristics and superior physical properties. This highly radiopaque hydrophilic sealer forms hydroxyapatite upon setting and chemically bonds to dentine. It sets with moisture naturally present within dentine.



## Indications

- Permanent obturation / filling of root canals.
- As a root canal sealer for teeth of the secondary dentition in combination with root canal points. (suitable for single cone and lateral condensation)

## Benefits

- Bioceramic technology for optimal results
- Permits adequate working time.
- Syringe for direct application
- Optimal flowability allows the sealer to fill difficult access areas
- High alkaline pH and antimicrobial property increases the success rate of endodontic treatments
- Radiopaque
- Non resorbable

## Chemistry

Calcium Silicates, Calcium Phosphates, Zirconium Oxide, Calcium Sulphate, Calcium Oxide, Fillers, Accelerators and thickening agents.

## Presentation

Ref. : 40037	Ref. : 40037-1 (Pouch Packing)	Ref. : 40037-2 (Box Packing)
♦ 1 x 1.2g Premixed Syringe	♦ 1 x 2g Premixed Syringe	♦ 1 x 2g Premixed Syringe
♦ 7 x Applicator Tips	♦ 10 x Applicator Tips	♦ 10 x Applicator Tips
♦ 1 x Instruction manual	♦ 1 x Instruction manual	♦ 1 x Instruction manual

## Technique

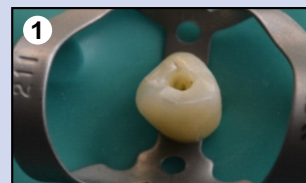

Irrigate the prepared root canals.  
Root canals must be kept moist



Method 1 : Full endodontic obturation  
by direct injection of Cerafill RCS paste

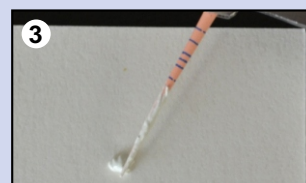

Method 2 : Endodontic obturation using a  
combination of Gutta percha and Cerafill RCS

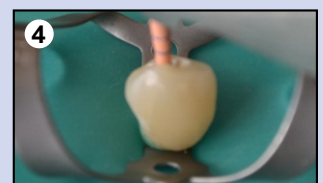

Method 2 : Endodontic obturation using a  
combination of Gutta percha and Cerafill RCS



Radio - opacity and 3D root canal filling of  
Cerafill RCS

## Technical Data

- 1) Film Thickness : 45 µm
- 2) Solubility : < 3
- 3) Setting Time : 10-24 hrs.

## PREVEST DENPRO LIMITED

Unit II, Export Promotion Industrial Park (EPIP),  
Bari Brahmana, Jammu-181133, India.

Tel.: + 91 191 350 6858, 60, 61  
Tel.: + 91 8899074151

E-mail : [info@prevestdenpro.com](mailto:info@prevestdenpro.com)  
Website : [www.prevestdenpro.com](http://www.prevestdenpro.com)

# Cerafill RCS®

Bioceramic Root Canal Filling and Sealing Material

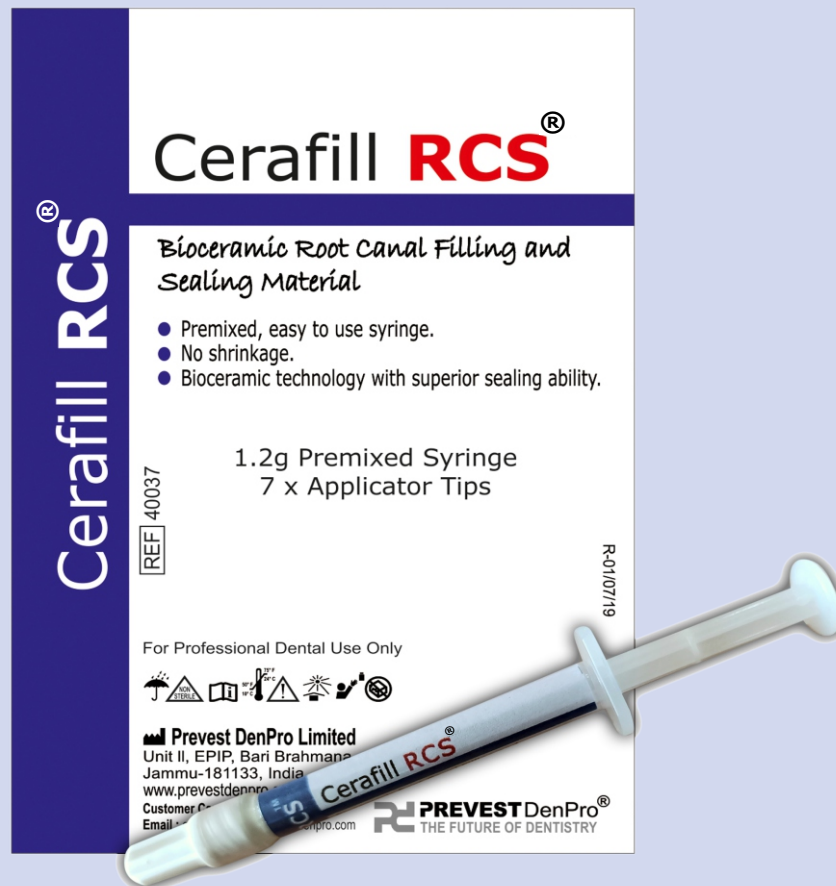

**Cerafill RCS** is a ready to use injectable premixed filling and sealing material which is based on the bioceramic technology. It is an alumina free calcium silicate based material with excellent handling characteristics and superior physical properties. This highly radiopaque hydrophillic sealer forms hydroxyapatite upon setting and chemically bonds to dentine. It sets with moisture naturally present within dentine.

## PREVEST DENPRO LIMITED

Unit II, Export Promotion Industrial Park (EPIP),  
Bari Brahmana, Jammu-181133, India.

Tel.: + 91 191 350 6858, 60, 61  
Tel.: + 91 8899074151

E-mail : [info@prevestdenpro.com](mailto:info@prevestdenpro.com)  
Website : [www.prevestdenpro.com](http://www.prevestdenpro.com)